

SINK & TAP COLLECTION

SWISS DESIGN SINCE 1911



MAKE IT WONDERFUL

FRANKE

CONTENTS

P2 - 5	Brand Introduction
P6 - 7	Innovation/ Awards
P8 - 12	Sink Overview
P13 - 24	Stainless Steel Sink
P25 - 29	Tap Overview
P30 - 32	Brass Tap
P33 - 35	Stainless Steel Tap
P36 - 38	Accessory
P39 - 40	Our Project

SWISS HERITAGE

Since 1911





Switzerland, a beautiful country with spectacular natural landscape and a rich history, is famous for its manufacturing excellence with uncompromising quality and design.

That's where our story began.

After pursuing detail, perfection and high quality for one century, we stand for reliable, premium products and have a strong reputation as dependable partner.

As a Swiss traditional brand with more than **100-year** history, we have expanded our business across **5** continents with **9,000** employees, owned **67** branches around **40** countries.

There are over 100 million households using Franke products.

OUR STORY

6 key milestones,

5 divisions,

1 successful story

Nowadays

Franke Group consists of five core business divisions: Franke Kitchen Systems, Franke Foodservice Systems, Franke Water Systems, and Franke Coffee Systems; Franke Kitchen Systems has become the world's leading provider of integrated kitchen system.



1911

Herman Franke established a sheet-metal business in Rorschach, Switzerland. In the early 1930s, Franke manufactured the first sink unit in nickeline, monel and later in stainless steel, and soon Franke started the series production and launched first fully welded, flush-mounted sink.



1946

Franke successfully exported to neighboring countries. Walter Franke drew up a model for the standardization of the private kitchen, which set kitchen technology standards still used today. In the following years, Franke kept further expansion to cover the whole Europe. Also, its business expanded from private kitchen to commercial kitchen, coffee machine and semi-/public washrooms.



1978

With the purchase of Progressive Corporation in Philadelphia USA, Franke took the first big step towards becoming a global company. During the next few years, Franke successfully continued to increase its footprint in the African markets.



1995

Franke entered China market, which was an important step of expanding business in Asia.

Since then, Franke has established efficient and economic manufacturing facilities all over the world. Franke consistently and successfully built the company into today's global Franke Group.



2005

Franke took over the Faber Group of Italy, one of the top hood manufacturers in the world. It has significantly strengthened Franke's capability of being an integrated kitchen system provider.



2013

Franke acquired the top class tap brand KWC in Switzerland, which raised our competitiveness in innovation and design. Meanwhile, it further enhanced Franke's high-end brand position and image.

INNOVATION IS IN OUR DNA

We have always been a passionate innovator since our foundation.



reddot design award
winner 2015

FRANKE BOX SINK
Red Dot Award 2015



reddot award 2016
winner

**FRAMES BY FRANKE
SEMIPRO TAP**
Red Dot Award 2016



reddot award 2016
winner

**FRAMES BY FRANKE
STAINLESS STEEL SINK**
Red Dot Award 2016



reddot design award
winner 2017

FRANKE STYLE SINK
iF Design Award 2017
Red Dot Award 2017



**FRAMES BY FRANKE
GRANITE SINK**
iF Design Award 2017



reddot design award
winner 2017

FRANKE PESCARA RANGE OF TAPS

iF Design Award 2017
Red Dot Award 2017



reddot design award
winner 2018

FRANKE CRYSTAL SEMI-PRO TAP

iF Design Award 2018
Red Dot Design Award 2018



FRANKE BOX CENTER

iF Design Award 2019



reddot design award
winner 2019

FRANKE KUBUS 2 RANGE OF FRAGRANITE SINKS

Red Dot Design Award 2019

OVERVIEW





Kitchen sinks that feel tailor-made

From classic style to modern you'll discover elegant design and exquisite craftsmanship without compromise. With Franke sinks, each detail is considered, right down to a patented integral ledge that helps make prepping and cleaning effortless.

Stainless Steel Sinks

Franke stainless steel sinks are made from premium quality 304 stainless chrome nickel steel. It is stunningly beautiful, and is highly stain, rust and corrosion resistant. What's more, it won't chip, craze, flake or break.

Franke offers sinks in a selection of stainless steel finishes, so whether you prefer the more reflective qualities of polished finishes, or the more subtle look of silk or brushed finishes, which give a more matt sheen, there is a stainless steel solution suited for you.

HIGHLIGHTS

Details that make the difference

Small details such as the annealing process for the material to be relieved, its forming history, or a highly innovative “fast-in” installation system make a huge difference. Whether it’s to save you time, make cleaning easier, boost performance or simply provide an efficient solution for life’s little challenges, every aspect of a Franke sink is carefully designed to make life easier.



Choosing your perfect sink

There are a number of considerations to take into account when choosing a sink. Not only should it accentuate the overall look and feel of your kitchen, but also there are installation and functionality aspects to take into account.

1.Material options

STAINLESS STEEL
FRAGRANITE

2.Installation Type*

INSET
FLUSHMOUNT
UNDERMOUNT

3.Number of Bowls

SINGLE BOWL

Single bowl sinks come in a variety of sizes, ideal for limited space or large spaces.

DOUBLE BOWL

Double bowl sinks offer great flexibility in the kitchen, providing more space, with additional options.



4. Cabinet size

The length and depth of the cabinet, on top of which the sink will be located, are the factors that determine the maximum size of an installed sink.

5. Bowl depth

The normal bowl depth usually ranges from 7-9 inches. A deeper bowl can make it easier to handle large pots and cookware, but the user's height should also be considered. A shallower bowl may provide greater comfort while working in and reaching the bottom of the sink.

Installation Type*

INSET

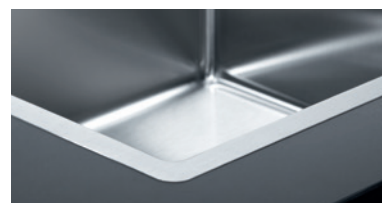

 INSET the most popular installation option: practical and easy.

FLUSHMOUNT

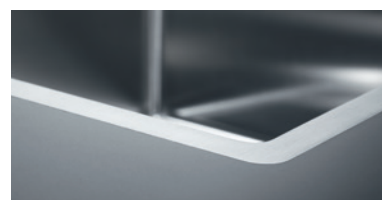

 FLUSHMOUNT a sophisticated design that enhances the look of the worktop.

UNDERMOUNT



 UNDERMOUNT an original, refined installation choice that allows bowls and sinks to be installed underneath marble or synthetic worktops, creating a surface with immaculate lines which is highly functional, elegant and easy to maintain.



STAINLESS STEEL SINK

MARIS

NEW

+ SWITZERLAND

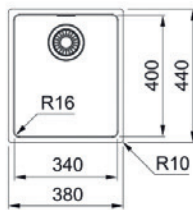

Model	MRX 110-34
Fun No	122.0531.850
Radius	16
Thickness	0.8mm
Overall Size	380 x 440mm (LxW)
Bowl Size	340 x 400 x 180mm (LxWxD)
Cut-out Size	340 x 400mm ,R16 (LxW)
Installation	Undermount
Included Accessory	Waste kit w/over flow
Suggested Retail Price	\$2,580

MARIS

NEW

+ SWITZERLAND

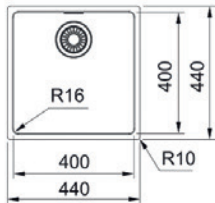

Model	MRX 110-40
Fun No	122.0531.643
Radius	16
Thickness	0.8mm
Overall Size	440 x 440mm (LxW)
Bowl Size	400 x 400 x 180mm (LxWxD)
Cut-out Size	400 x 400mm ,R16 (LxW)
Installation	Undermount
Included Accessory	Waste kit w/over flow
Suggested Retail Price	\$2,680

MARIS

NEW

+ SWITZERLAND

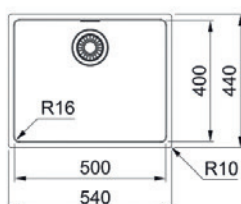

Model	MRX 110-50
Fun No	122.0531.808
Radius	16
Thickness	0.8mm
Overall Size	540 x 440mm (LxW)
Bowl Size	500 x 400 x 180mm (LxWxD)
Cut-out Size	500 x 400mm ,R16 (LxW)
Installation	Undermount
Included Accessory	Waste kit w/over flow
Suggested Retail Price	\$2,980

STAINLESS STEEL SINK

MARIS

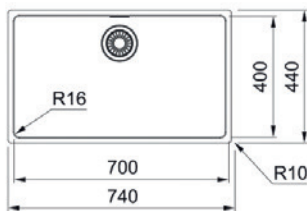

NEW

+ SWITZERLAND

Model	MRX 110-70
Fun No	122.0531.911
Radius	16
Thickness	0.8mm
Overall Size	740 x 440mm (LxW)
Bowl Size	700 x 400 x 180mm (LxWxD)
Cut-out Size	700 x 400mm ,R16 (LxW)
Installation	Undermount
Included Accessory	Waste kit w/over flow
Suggested Retail Price	\$3,880

MARIS

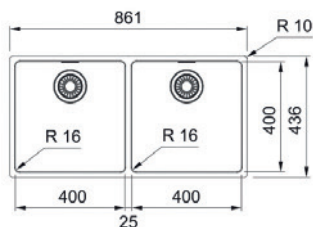

NEW

+ SWITZERLAND

Model	MRX 120-40-40
Fun No	122.0531.854
Radius	16
Thickness	0.8mm
Overall Size	865 x 440mm (LxW)
Bowl Size	400 x 400 x 180mm (LxWxD)
Cut-out Size	400 x 400 x 180mm (LxWxD)
Installation	Undermount
Included Accessory	Waste kit w/over flow
Suggested Retail Price	\$5,880

STAINLESS STEEL SINK

PLANAR

ITALY

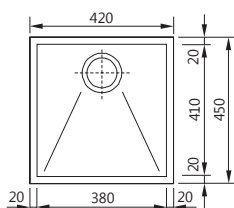

Model	PPX 110-38
Fun No	122.0203.472
Radius	0
Thickness	1mm
Overall Size	420 x 450 x 200mm (LxWxD)
Bowl Size	380 x 410 x 200mm (LxWxD)
Cut-out Size	390 x 410mm (LxW)
Installation	Undermount
Included Accessory	Waste kit w/over flow
Suggested Retail Price	\$4,530

PLANAR

ITALY

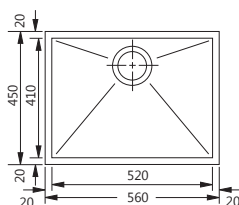

Model	PPX 110-52
Fun No	122.0203.471
Radius	0
Thickness	1mm
Overall Size	560 x 450 x 200mm (LxWxD)
Bowl Size	520 x 410 x 200mm (LxWxD)
Cut-out Size	520 x 410mm (LxW)
Installation	Undermount
Included Accessory	Waste kit w/over flow
Suggested Retail Price	\$4,750

PLANAR

ITALY

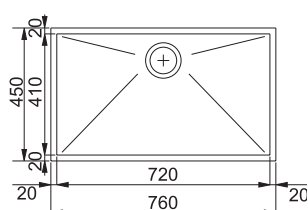

Model	PPX 110-72
Fun No	122.0198.208
Radius	0
Thickness	1mm
Overall Size	760 x 450 x 200mm (LxWxD)
Bowl Size	720 x 410 x 200mm (LxWxD)
Cut-out Size	720 x 410mm (LxW)
Installation	Undermount
Included Accessory	Waste kit w/over flow
Suggested Retail Price	\$5,540

STAINLESS STEEL SINK

PLANAR

ITALY

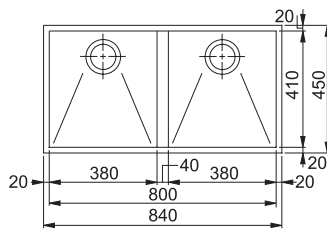

Model	PPX 120
Fun No	122.0198.200
Radius	0
Thickness	1mm
Overall Size	840 x 450 x 200mm (LxWxD)
Bowl Size	380 x 410 x 200mm (LxWxD)
	380 x 410 x 200mm (LxWxD)
Cut-out Size	800 x 410mm (LxW)
Installation	Undermount
Included Accessory	Waste kit w/over flow
Suggested Retail Price	\$6,710

PLANAR

ITALY

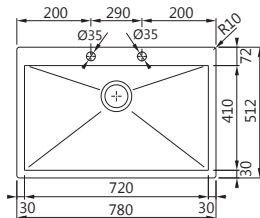

Model	PPX 210-78 TL
Fun No	127.0198.197
Radius	0
Thickness	1mm
Overall Size	780 x 512 x 200mm (LxWxD)
Bowl Size	720 x 410 x 200mm (LxWxD)
Cut-out Size	760 x 492mm (LxW)
Installation	Inset, flushmount, undermount
Included Accessory	Waste kit w/over flow
Suggested Retail Price	\$7,800

PLANAR

ITALY

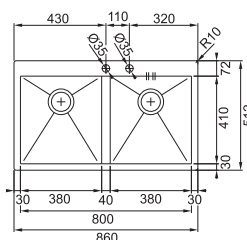

Model	PPX 220 TL
Fun No	127.0198.193
Radius	0
Thickness	1mm
Overall Size	860 x 512 x 200mm (LxWxD)
Bowl Size	380 x 410 x 200mm (LxWxD)
	380 x 410 x 200mm (LxWxD)
Cut-out Size	840 x 492mm (LxW)
Installation	Inset, flushmount, undermount
Included Accessory	Waste kit w/over flow
Suggested Retail Price	\$9,040

STAINLESS STEEL SINK

GALASSIA

ITALY

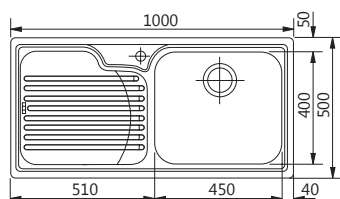

Model	GAX 611 LHD / RHD
Fun No	101.0017.508 / 101.0017.509
Radius	—
Thickness	0.8mm
Overall Size	1000 x 500 x 205mm (LxWxD)
Bowl Size	450 x 400 x 180mm (LxWxD)
Cut-out Size	980 x 480mm (LxW)
Installation	Inset
Included Accessory	Waste kit w/over flow
Suggested Retail Price	\$3,080

GALASSIA

ITALY

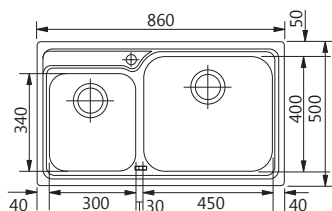

Model	GAX 620
Fun No	101.0017.507
Radius	—
Thickness	0.8mm
Overall Size	860 x 500 x 205mm (LxWxD)
Bowl Size	450 x 400 x 180mm (LxWxD)
Cut-out Size	300 x 340 x 170mm (LxWxD)
Installation	Inset
Included Accessory	Waste kit w/over flow
Suggested Retail Price	\$3,780

GALASSIA

ITALY

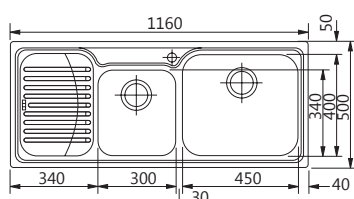

Model	GAX 621 LHD / RHD
Fun No	101.0017.504 / 101.0017.506
Radius	—
Thickness	0.8mm
Overall Size	1160 x 500 x 205mm (LxWxD)
Bowl Size	450 x 400 x 180mm (LxWxD)
Cut-out Size	300 x 340 x 170mm (LxWxD)
Installation	Inset
Included Accessory	Waste kit w/over flow
Suggested Retail Price	\$4,080

STAINLESS STEEL SINK

GALASSIA

ITALY

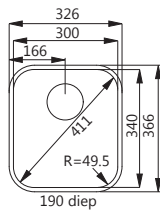

Model	GAX 110-30
Fun No	122.0021.439
Radius	49.5
Thickness	0.8mm
Overall Size	332 x 372 x 170mm (LxWxD)
Bowl Size	300 x 340 x 170mm (LxWxD)
Cut-out Size	300 x 340mm (LxW)
Installation	Undermount
Included Accessory	Waste kit w/over flow
Suggested Retail Price	\$1,580

GALASSIA

ITALY

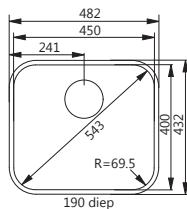

Model	GAX 110-45
Fun No	122.0021.440
Radius	69.5
Thickness	0.8mm
Overall Size	482 x 432 x 180mm (LxWxD)
Bowl Size	450 x 400 x 180mm (LxWxD)
Cut-out Size	450 x 400mm (LxW)
Installation	Undermount
Included Accessory	Waste kit w/over flow
Suggested Retail Price	\$1,880

STAINLESS STEEL SINK

BOX

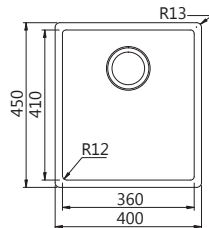

Model	BXX 210-36
Fun No	127.0554.200
Radius	12
Thickness	1.2mm
Overall Size	400 x 450 x 200mm (LxWxD)
Bowl Size	360 x 410 x 200mm (LxWxD)
Cut-out Size	370 x 420mm (LxW)
Installation	Inset, flushmount, undermount
Included Accessory	Waste kit w/over flow
Suggested Retail Price	\$2,460

BOX

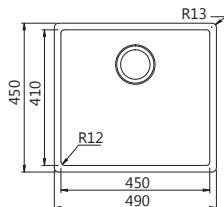

Model	BXX 210-45
Fun No	127.0554.251
Radius	12
Thickness	1.2mm
Overall Size	490 x 450 x 200mm (LxWxD)
Bowl Size	450 x 410 x 200mm (LxWxD)
Cut-out Size	460 x 420mm (LxW)
Installation	Inset, flushmount, undermount
Included Accessory	Waste kit w/over flow
Suggested Retail Price	\$2,660

BOX

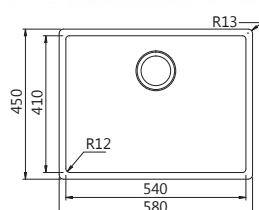

Model	BXX 210-54
Fun No	127.0554.252
Radius	12
Thickness	1.2mm
Overall Size	580 x 450 x 200mm (LxWxD)
Bowl Size	540 x 410 x 200mm (LxWxD)
Cut-out Size	550 x 420mm (LxW)
Installation	Inset, flushmount, undermount
Included Accessory	Waste kit w/over flow
Suggested Retail Price	\$2,760

STAINLESS STEEL SINK

BOX

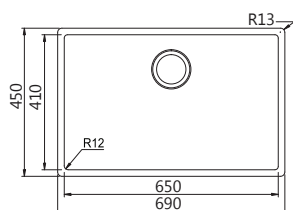

Model	BXX 210-65
Fun No	127.0554.253
Radius	12
Thickness	1.2mm
Overall Size	690 x 450 x 200mm (LxWxD)
Bowl Size	650 x 410 x 200mm (LxWxD)
Cut-out Size	660 x 420mm (LxW)
Installation	Inset, flushmount, undermount
Included Accessory	Waste kit w/over flow
Suggested Retail Price	\$2,960

BOX

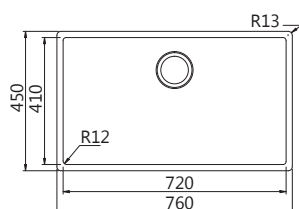

Model	BXX 210-72
Fun No	127.0554.254
Radius	12
Thickness	1.2mm
Overall Size	760 x 450 x 200mm (LxWxD)
Bowl Size	720 x 410 x 200mm (LxWxD)
Cut-out Size	730 x 420mm (LxW)
Installation	Inset, flushmount, undermount
Included Accessory	Waste kit w/over flow
Suggested Retail Price	\$3,660

BOX

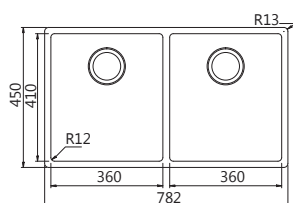

Model	BXX 220-36-36
Fun No	127.0434.706
Radius	12
Thickness	1.2mm
Overall Size	782 x 450 x 200mm (LxWxD)
Bowl Size	360 x 410 x 200mm (LxWxD)
Cut-out Size	752 x 420mm (LxW)
Installation	Inset, flushmount, undermount
Included Accessory	Waste kit w/over flow
Suggested Retail Price	\$4,860

STAINLESS STEEL SINK

BOX

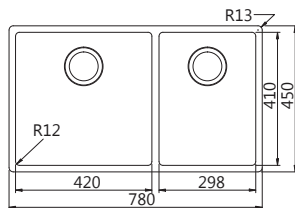

Model	BXX 220-74 SBL / SBR
Fun No	127.0554.256 / 127.0554.255
Radius	12
Thickness	1.2mm
Overall Size	780 x 450 x 200mm (LxWxD)
Bowl Size	420 x 410 x 200mm (LxWxD) 298 x 410 x 200mm (LxWxD)
Cut-out Size	750 x 420mm (LxW)
Installation	Inset, flushmount, undermount
Included Accessory	Waste kit w/over flow
Suggested Retail Price	\$4,960

BOX

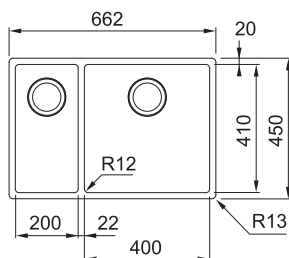

Model	BXX 260-40 SBL / SBR
Fun No	127.0554.258 / 127.0554.257
Radius	12
Thickness	1.2mm
Overall Size	662 x 450 x 200mm (LxWxD)
Bowl Size	400 x 410 x 200mm (LxWxD) 200 x 410 x 200mm (LxWxD)
Cut-out Size	632 x 420mm (LxW)
Installation	Inset, flushmount, undermount
Included Accessory	Waste kit w/over flow
Suggested Retail Price	\$4,360

STAINLESS STEEL SINK

BELL

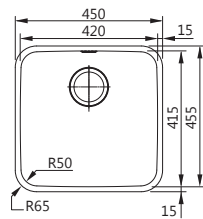

Model	BCX 110-42
Fun No	122.0438.077
Radius	50
Thickness	0.8mm
Overall Size	450 x 445mm (LxW)
Bowl Size	420 x 415 x 200mm (LxWxD)
Cut-out Size	420 x 415mm ,R50 (LxW)
Installation	Undermount
Included Accessory	-
Suggested Retail Price	\$1,050

BELL

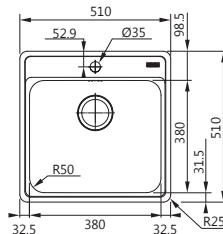

Model	BCX 610-51
Fun No	101.0438.083
Radius	50
Thickness	0.8mm
Overall Size	510 x 510mm (LxW)
Bowl Size	445 x 380 x 200mm (LxWxD)
Cut-out Size	486 x 486mm ,R10 (LxW)
Installation	Inset
Included Accessory	-
Suggested Retail Price	\$1,350

BELL

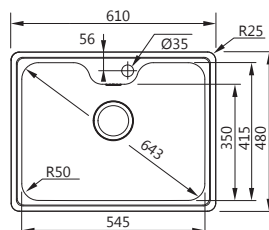

Model	BCX 610-61
Fun No	101.0393.024
Radius	50
Thickness	0.8mm
Overall Size	610 x 480mm (LxW)
Bowl Size	545 x 415 x 200mm (LxWxD)
Cut-out Size	586 x 456mm ,R10 (LxW)
Installation	Inset
Included Accessory	-
Suggested Retail Price	\$1,550

STAINLESS STEEL SINK

BELL

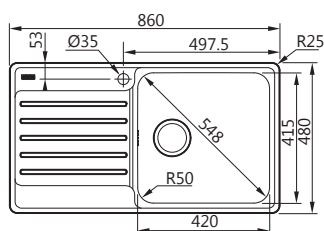

Model	BCX 611-86 LHD / RHD
Fun No	101.0438.085 / 101.0438.087
Radius	50
Thickness	0.8mm
Overall Size	860 x 480mm (LxW)
Bowl Size	420 x 415 x 200mm (LxWxD)
	420 x 415 x 200mm (LxWxD)
Cut-out Size	836 x 456mm ,R10 (LxW)
Installation	Inset
Included Accessory	-
Suggested Retail Price	\$1,820

BELL

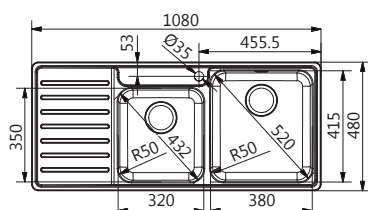

Model	BCX 621 LHD / RHD
Fun No	101.0547.021 / 101.0438.093
Radius	50
Thickness	0.8mm
Overall Size	1080 x 480mm (LxW)
Bowl Size	380 x 415 x 180mm (LxWxD)
	320 x 350 x 160mm (LxWxD)
Cut-out Size	1056 x 456mm ,R10 (LxW)
Installation	Inset
Included Accessory	-
Suggested Retail Price	\$2,340

BELL

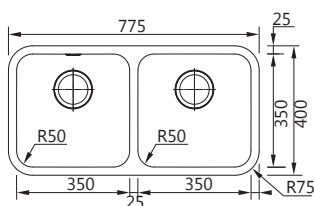

Model	BCX 120-35-35
Fun No	122.0438.133
Radius	50
Thickness	0.8mm
Overall Size	775 x 400mm (LxW)
Bowl Size	350 x 350 x 180mm (LxWxD)
	350 x 350 x 180mm (LxWxD)
Cut-out Size	725 x 350mm ,R50 (LxW)
Installation	Undermount
Included Accessory	-
Suggested Retail Price	\$1,420

STAINLESS STEEL SINK

BELL

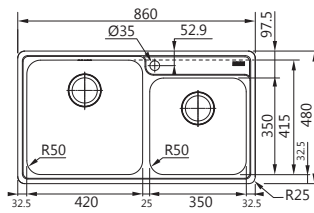

Model	BCX 620-42-35
Fun No	101.0438.090
Radius	50
Thickness	0.8mm
Overall Size	860 x 480mm (LxW)
Bowl Size	420 x 415 x 200mm (LxWxD) 350 x 350 x 180mm (LxWxD)
Cut-out Size	836 x 456mm ,R10 (LxW)
Installation	Inset
Included Accessory	-
Suggested Retail Price	\$2,020

OVERVIEW

Taps worth talking about



The perfect kitchen tap combines form and function, making your life easier and your kitchen look more beautiful. Franke taps are a superior choice renowned for our extraordinary design, high quality components, and stringent manufacturing processes. With the acquisition of KWC Switzerland, Franke has gained a strong partner and increased expertise in high-end tap manufacturing and design.



Fragranite tap

For the perfect match with a Fraganite sink, choose a color tap, with its various colors, all of which are compatible with a Fraganite sink. The Fraganite sink & tap set has the look of a masterpiece - the perfect partnership!

Stainless Steel tap

Stainless Steel as a base material is durable and easy to maintain. It is also lead free, making it completely safe for your family. One advantage of brushed stain finishing is that it matches with stainless steel sinks and appliances.



Brass tap

Brass is one of the most common materials in tap making, and brass taps can be found all around the world. Its material characteristics make it possible to create a wide range of tap shapes and styles. Chrome finishing provides a shiny look that fits perfectly with contemporary kitchen styles.

HIGHLIGHTS

Design

Franke's line of kitchen taps perfectly captures all the elements of today's design choices – traditional, transitional, and contemporary. With everything from top flight European models with a sleek minimalist line, to sumptuous classic models that are the centerpiece to any kitchen, the addition of a Franke tap can reinvigorate an existing kitchen or make a statement all its own in a fresh design.

Manufacturing

Outstanding design and quality components come together beautifully during the Franke manufacturing process. Strict adherence to Franke manufacturing standards in forming, finishing and final assembly achieve the exceptional quality and durability that makes a Franke tap one of the most desired additions to a kitchen.



FRANKE KITCHEN TAP

An inspiration of beauty, the combination of form and function - Franke kitchen tap will make your life easier and your kitchen more beautiful.



Hygiene

Superior material with corrosion resistant and easy cleaning ability guarantees the passing water natural without harmful materials added.



Durability

Scratch and acid resistant features of high quality SUS304 stainless steel ensures our tap have a much longer lifecycle.



Functionality

Ceramic cartridge provides uniform temperature and water flow transmission as well as excellent water saving characteristics.



Design Award

Franke Pescara range of taps received iF Gold Award as well as Red Dot design award in 2017, thanks to its outstanding quality and cutting-edge design.

BRASS TAP

NEW

ITALY

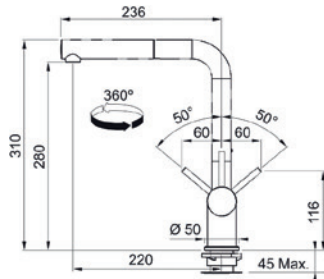

Model	Active Plus Pull Out Graphite
Fun No	115.0373.890
Material	Brass
Finish	Graphite
Pull Out	Yes
Nozzle / Spray	Nozzle
Hose Diameter	3/8"

Suggested Retail Price \$2,680

ITALY

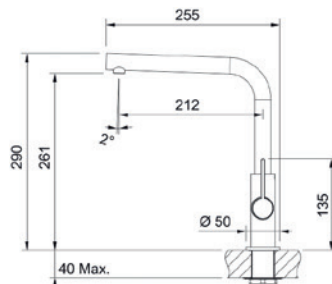

Model	PT 207C
Fun No	115.0373.928
Material	Brass
Finish	Chrome
Pull Out	No
Nozzle / Spray	Nozzle
Hose Diameter	3/8"
General Acceptance	No. C20160310 

Suggested Retail Price \$1,650

ITALY

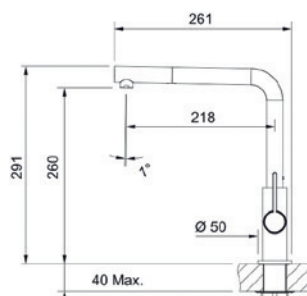

Model	PT 231C
Fun No	115.0373.943
Material	Brass
Finish	Chrome
Pull Out	Yes
Nozzle / Spray	Nozzle
Hose Diameter	3/8"
General Acceptance	No. C20161054 

Suggested Retail Price \$2,380



BRASS TAP

NEW

ITALY

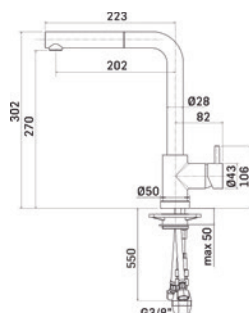

Model	PT 935C
Fun No	115.0556.848
Material	Brass
Finish	Chrome
Pull Out	Yes
Nozzle / Spray	Nozzle
Hose Diameter	3/8"
Suggested Retail Price	\$1,830

NEW

ITALY

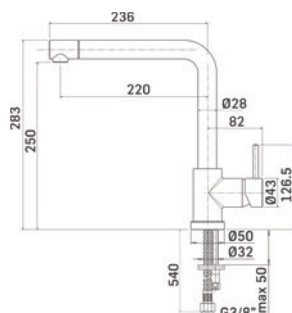

Model	PT 902C
Fun No	115.0556.849
Material	Brass
Finish	Chrome
Pull Out	No
Nozzle / Spray	Nozzle
Hose Diameter	3/8"
Suggested Retail Price	\$1,530

NEW

ITALY

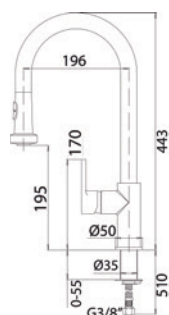

Model	PT 992C
Fun No	115.0556.850
Material	Brass
Finish	Chrome
Pull Out	Yes
Nozzle / Spray	Spray
Hose Diameter	3/8"
Suggested Retail Price	\$2,580

BRASS TAP

NEW

ITALY



Model	PT 903C
Fun No	115.0556.861
Material	Brass
Finish	Chrome
Pull Out	No
Nozzle / Spray	Nozzle
Hose Diameter	3/8"
Suggested Retail Price	\$1,320

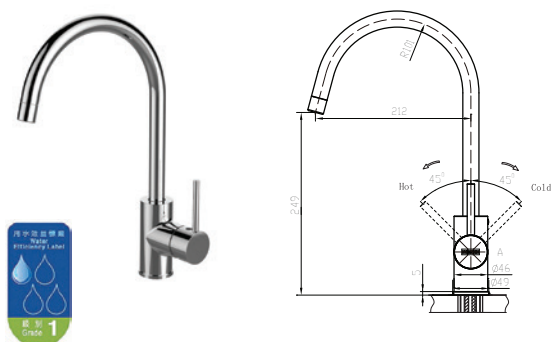

Model	CT 9015C
Fun No	115.0553.689
Material	Brass
Finish	Chrome
Pull Out	No
Nozzle / Spray	Nozzle
Hose Diameter	3/8"
General Acceptance	No. C20180801 
Suggested Retail Price	\$1,080

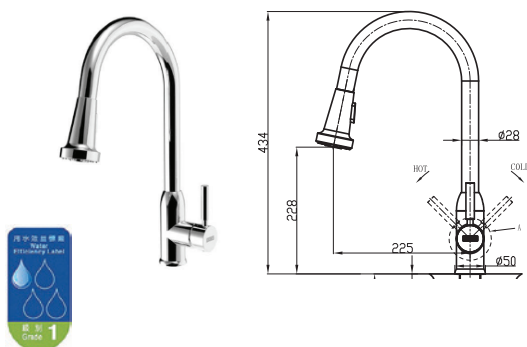

Model	CT 2011C
Fun No	115.0553.690
Material	Brass
Finish	Chrome
Pull Out	Yes
Nozzle / Spray	Spray
Hose Diameter	3/8"
General Acceptance	No. C20190288 
Suggested Retail Price	\$1,630

STAINLESS STEEL TAP

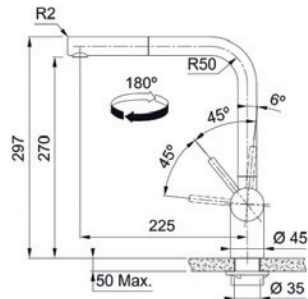

Model	CT 1310S
Fun No	115.0521.438
Material	Stainless Steel
Finish	Satin
Pull Out	Yes
Nozzle / Spray	Nozzle
Hose Diameter	3/8"
Suggested Retail Price	\$1,880

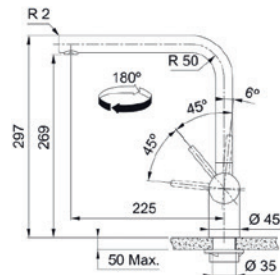

Model	CT 1012S
Fun No	115.0521.435
Material	Stainless Steel
Finish	Satin
Pull Out	No
Nozzle / Spray	Nozzle
Hose Diameter	3/8"
Suggested Retail Price	\$1,530

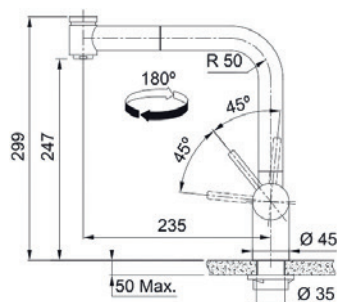

Model	CT 196S
Fun No	115.0521.441
Material	Stainless Steel
Finish	Satin
Pull Out	Yes
Nozzle / Spray	Spray
Hose Diameter	3/8"
Suggested Retail Price	\$2,320

STAINLESS STEEL TAP

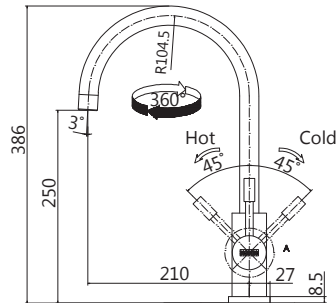

Model	CT 103S
Fun No	115.0051.756
Material	Stainless Steel
Finish	Satin
Pull Out	No
Nozzle / Spray	Nozzle
Hose Diameter	1/2"
Suggested Retail Price	\$2,280

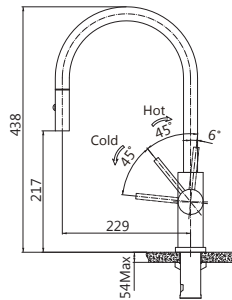

Model	CT 193S
Fun No	115.0479.992
Material	Stainless Steel
Finish	Satin
Pull Out	Yes
Nozzle / Spray	Spray
Hose Diameter	1/2"
Suggested Retail Price	\$2,380

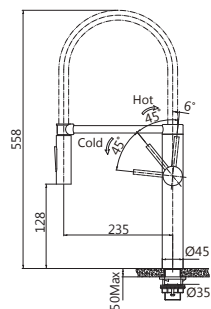

Model	CT 194S
Fun No	115.0479.970
Material	Stainless Steel
Finish	Satin
Pull Out	Yes
Nozzle / Spray	Spray
Hose Diameter	1/2"
Suggested Retail Price	\$2,960

STAINLESS STEEL TAP

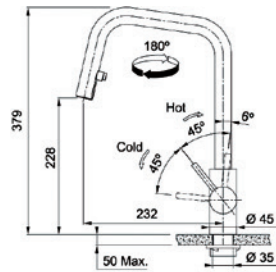

Model	CT 197S
Fun No	115.0529.207
Material	Stainless Steel
Finish	Satin
Pull Out	Yes
Nozzle / Spray	Spray
Hose Diameter	3/8"
Suggested Retail Price	\$2,200

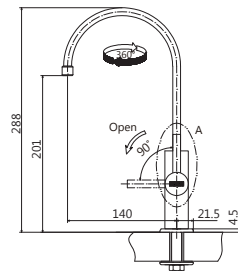

Model	CF 01S
Fun No	115.0156.115
Material	Stainless Steel
Finish	Satin
Pull Out	No
Nozzle / Spray	Nozzle
Hose Diameter	—
Suggested Retail Price	\$1,090

FRANKE BELL RANGE **ACCESSORY**



Type Chopping Board
Model 220-285
Fun 112.0437.908
Size 366 x 220 x 18mm
Material Rubber Wood
Suggested Retail Price
\$160



Type Chopping Board
Model 200-298
Fun 112.0505.218
Size 435 x 220 x 23mm
Material Rubber Wood
Suggested Retail Price
\$210



Type Wire Basket
Model 210-423
Fun 112.0504.639
Size 300 x 385 x 100mm
Material Stainless Steel
Suggested Retail Price
\$270

BCX 110-42



BCX 610-51



BCX 610-61



BCX 611-86 (LHD/RHD)



BCX 621 (LHD/RHD)



BCX 120-35-35



BCX 620-38-42



BCX 620-42-35



BCX 620-35-35



FRANKE BOX RANGE **ACCESSORY**



Type Chopping Board
Model 200-291
Fun 112.0480.098
Size 428 x 336 x 25.5mm
Material Wooden
Suggested Retail Price
\$320



Type Chopping Board
Model 200-292
Fun 112.0462.252
Size 430 x 225 x 18mm
Material Bamboo
Suggested Retail Price
\$210



Type Stainer Bowl
Model 230-093
Fun 112.0394.981
Size 429 x 150 x 50mm
Material Stainless Steel 304 & Polypropylene
Suggested Retail Price
\$610



Type Roller Matt
Model 210-414
Fun 112.0188.183
Size 468 x 440mm
Material Stainless Steel
Suggested Retail Price
\$480



Type Wire Basket
Model 230-098
Fun 112.0437.935
Size 340 x 305 x 150mm
Material Stainless Steel
Suggested Retail Price
\$330



Type Strainer Bowl
Model 230-102
Fun 112.0493.808
Size 366 x 160 x 85mm
Material Polypropylene
Suggested Retail Price
\$60



Type Strainer Bowl
Model 230-104
Fun 112.0493.951
Size 435 x 190 x 85mm
Material Polypropylene
Suggested Retail Price
\$80



Type Strainer Bowl
Model 230-105
Fun 112.0493.952
Size 465 x 190 x 85mm
Material Polypropylene
Suggested Retail Price
\$90



FRANKE MARIS RANGE **ACCESSORY**



Type Chopping Board
Fun 112.0530.071
Size 200 x 440 x 16mm
Material Polypropylene
Suggested Retail Price
\$380



Type Strainer Bowl
Fun 112.0057.850
Size 172 x 412 x 57mm
Material Stainless Steel
Suggested Retail Price
\$710



Type Mobile Drainer
Fun 112.0188.651
Size 430 x 342 x 22mm
Material Stainless Steel 304 & Polypropylene
Suggested Retail Price
\$1,380



Type Roller Matt
Fun 112.0030.882
Size 468 x 420mm
Material Stainless Steel
Suggested Retail Price
\$930

FRANKE BOX & BELL RANGE **ACCESSORY**



Type Waste Kit
Model 440-144
Fun 112.0180.412
Suggested Retail Price
\$100



Type Waste Kit
Model 440-153
Fun 112.0180.399
Suggested Retail Price
\$210



Type Waste Kit
Model 440-179
Fun 112.0481.339
Suggested Retail Price
\$260

BOX

BXX 210-36	●	●	●
BXX 210-45	●	●	●
BXX 210-54	●	●	●
BXX 210-65	●	●	●
BXX 210-72	●	●	●
BXX 220-36-36	●	●	●
BXX 220-74 SBL/SBR	●	●	●
BXX 260-40 SBL/SBR	●	●	●

BELL

BCX 110-42	●	●	●
BCX 610-51	●	●	●
BCX 610-61	●	●	●
BCX 611-86 (LHD/RHD)	●	●	●
BCX 621 (LHD/RHD)	●	●	●
BCX 120-35-35	●	●	●
BCX 620-38-42	●	●	●
BCX 620-42-35	●	●	●
BCX 620-35-35	●	●	●

PROJECT REFERENCE

(BY ASCENDING ORDER)

HONG KONG

PROJECT	DEVELOPER
Billionnaire Avant 御門·前	Chinachem 華懋
Cathay Pacific Cargo Terminal HK 國泰航空貨運站	Cathay Pacific Airlines Ltd. 國泰航空
Centre Point 尚賢居	Henderson Land 恒基
Cityplaza Phase 3 太古城中心3期	Swire Properties 太古
Dragons Range 玫瑰山	Kerry 嘉里
Eden Gate 雲門	Chinachem 華懋
Eltanin Square Mile 利奧坊·曉岸	Henderson Land 恒基
Facebook Hong Kong	Facebook Hong Kong 南豐
Grand Hyatt HK Renovation 香港君悅酒店	Grand Hyatt 君悅酒店
Harmony Place 樂融軒	Housing Society 香港房屋協會
HKUST Campus 香港科技大學	HKUST 香港科技大學
Horizon Suite Hotel 海澄軒	Cheung Kong Holdings 長江
Island Garden 香島	Nan Fung 南豐
JW Marriot HK 萬豪酒店	Marriott International Group 萬豪
K.K. Leung Building, HKU 香港大學梁銑琚樓	HKU 香港大學
Lepont 上源	Vanke 萬科
MacPherson Place 麥花臣匯	Kowloon Development 九龍建業
Mantin Heights 皓畋	Kerry 嘉里
Maya 曦臺	Wang On 宏安
Mount Nicholson	Wheelock 會德豐
1 Oxforad Road 牛津道一號	China Overseas 中國海外
77 Peak Road 山頂道77號	Wheelock會德豐
11 Plantation Road 種植道11號	Wheelock會德豐
Providence Bay Clubhouse 天賦海灣	Nan Fung 南豐

PROJECT REFERENCE

(BY ASCENDING ORDER)

HONG KONG

PROJECT	DEVELOPER
Rosewood Hotel 瑰麗酒店	New World Development 新世界
So Kwun Wat TMTL 500	Evergrande 恆大
ST. Martin 雲滙	Sun Hung Kai Properties 新鴻基
St. Paul's Hospital 聖保祿醫院	St. Paul's Hospital 聖保祿醫院
The Beaumont 峻滢	Cheung Kong Holdings 長江
The Bloomsway 滿名山	Kerry 嘉里
The Hong Kong Polytechnic University 香港理工大學	The Hong Kong Polytechnic University 香港理工大學
The Signature 春暉8號	New World Development 新世界
The Visionary 昇薈	Nan Fung 南豐
Towngas Cooking Center Causeway Bay 銅鑼灣煤氣烹飪中心	Towngas 中華煤氣
Vibe Centro 龍譽	Poly Property 保利置業
Winfield 雲暉大廈	Nan Fung 南豐

MACAU

PROJECT	DEVELOPER
JW Marriot, Galaxy Resort, Macau 萬豪酒店	Galaxy Entertainment Group 銀河娛樂
La Marina 海上居	Polytec Asset Group 保利達
MGM Cotai Macau 美獅美高梅酒店	MGM China Holdings 美高梅中國控股
Nova City Phase 5 豪庭都會	Shun Tak 信德
Rua da Ribeira do Patane, Macau 鏡湖醫院	鏡湖醫院基金會
The Venetian Hotel Resort, Macau 澳門威尼斯人	The Venetian Macau Limited 澳門威尼斯人

Make
it
Wonderful

Franke Kitchen Systems
www.franke.com.hk

恒威集團特約分銷商
Authorised Dealer of The B.S.C. Group
07/19

All pictures, specifications and other content in this catalogue are the property of Franke and shall not be reproduced in any form of media without the expressed written permission from Franke.

All product images and specifications are subject to the actual technical data. Franke reserves the right to make any changes and modifications, without prior notice, resulted from technology development.

Printed in July 2019 (Ver.1)

